

# Rough Terrain Scissor Lift

**Snorkel**  
www.snorkel.com.au

**SR4084**



- ☐ 14m maximum working height
- ☐ Drive motion alarm
- ☐ Hydraulic outriggers
- ☐ Large 1.3m roll out deck extension
- ☐ 340kg platform capacity
- ☐ Two wheel parking brakes
- ☐ High engine temperature and low oil pressure engine shut down
- ☐ Driveable at full height
- ☐ Joystick control on removeable console
- ☐ 4 wheel drive system
- ☐ Drive motion alarm
- ☐ 4 wheel drive, diesel power, and a large platform with a standard roll-out extension deck make these heavy-duty scissorlifts the right choice for rough terrain applications.

## Other Snorkel Work Platforms

Snorkel also manufactures a range of other work platforms including both small & large scissor lifts, trailer boom units, truck mounted boom machines, and large telescoping boom machines. Many of these units are available with alternative power sources including 24V DC options.

Truck Mounted Boom



Trailer Mounted Boom



Personal Lift



Self Propelled Boom



**Snorkel**

Manufacturing Plant: 36 Bruce Road, Levin, New Zealand  
Telephone: (06) 368-9168  
Facsimile: (06) 368-9164

# SR4084 Scissor Lift (Rough Terrain)

## TECHNICAL DATA

### PLATFORM

Height .....	39'10" (12.1 m)
Size .....	6' x 10' (1.8 x 3 m)
Rollout Extension .....	4' (1.3 m)
Platform Length – extended .....	168" (427 cm)
Capacity .....	750 lbs. (340 kg)
Capacity on Rollout Extension .....	350 lbs. (158 kg)

### MACHINE DIMENSIONS

Overall Stowed Height .....	105" (2.7 m)
Overall Width .....	7' (2.1 m)
Overall Length .....	149" (3.8 m)
Wheelbase .....	7'5 1/2" (2.3 m)
Weight .....	0,320 lbs. (4,685 kg)
Ground clearance .....	6" (15.2 cm)
Tire size/Type .....	26 x 12 (Foam filled)

### PERFORMANCE

Power Source .....	Liquid cooled Gas/Diesel
Gradeability .....	30%
Drive Speed – Elevated .....	0.4 mph (0.6 km/h)
Drive Speed – Stowed .....	2.2 mph (3.5 km/h)
Maximum drive height .....	32' (9.75 m)
Turning radius outside .....	8'10" (2.7 m)
Turning radius inside .....	16'7" (5.1 m)

## OPTIONS

- Horn
- Flashing Light
- Battery Condition Indicator
- Lanyard Anchors
- Key Switch
- Swing Gate
- AC Generator
- Big Paw Pneumatic tires

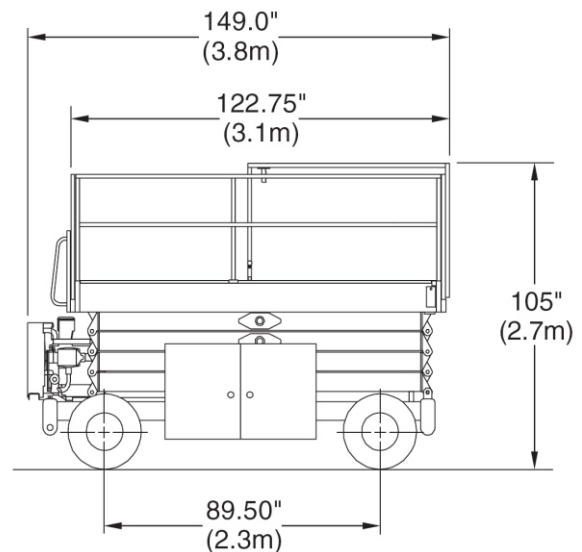
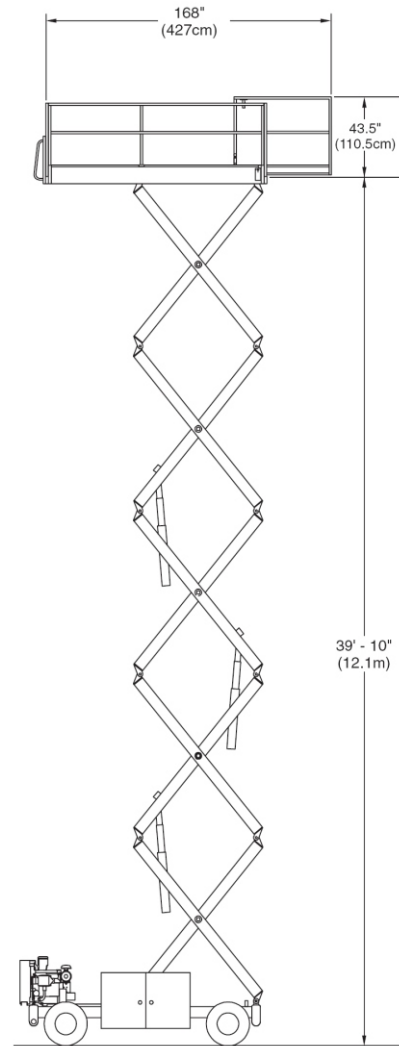

Danger: Standard models described in this brochure are NON-INSULATED and do not provide electrocution protection from contact with or close proximity to energised conductors which is pointed out on the decals and placards attached to the machine.

Products in this brochure comply with relevant ANSI and Australian Standards. This literature is for illustrative purposes only. Consult Operating/Maintenance and Parts Manuals for proper procedures. Specifications may vary and are subject to change without notice.

# Snorkel

[www.snorkel.com.au](http://www.snorkel.com.au)