

STIHL®

STIHL FW 20 - TS 700, 800

Gebrauchsanleitung
Instruction Manual
Notice d'emploi
Manual de instrucciones



Uputa za uporabu
Skötselavvisning
Käyttöohje
Istruzioni d'uso
Betjeningsvejledning
Bruksanvisning
Návod k použití
Használati utasítás
Instruções de serviço
Návod na obsluhu
Handleiding
Инструкция по эксплуатации
Lietošanas instrukcija
Інструкція з експлуатації
οδηγίες χρήσης
取扱説明書
Instrukcja użytkowania
Kasutusjuhend
Ekspluatavimo instrukcija
Ръководство за употреба
Navodilo za uporabo



Contents

Cut-off Machine Cart	6
Mounting	6

Original Instruction Manual

Printed on chlorine-free paper
Printing inks contain vegetable oils, paper can be recycled.

© ANDREAS STIHL AG & Co. KG, 2016
0458-537-9921-A_VA2.G16.
0000000856_005_GB



FW 20 - TS 700, TS 800

This instruction manual is protected by copyright. All rights reserved, especially the rights to reproduce, translate and process with electronic systems.

Cut-off Machine Cart

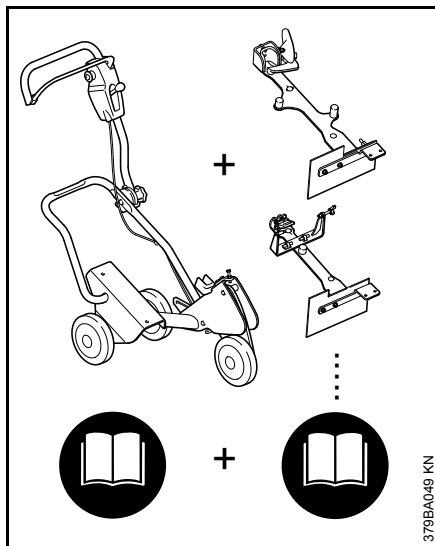

A basic machine **and** an attachment kit are combined to produce a complete cart FW 20.

The complete instruction manual for the cart FW 20 therefore consists of two instruction manuals – one for the basic machine FW 20 **and** one for the attachment kit FW-TS.

Always read **both** instruction manuals carefully before using your machine for the first time and keep them safe for future reference.

Additionally, observe the instruction manual of the cut-off machine used.

Mounting

Installing the mount

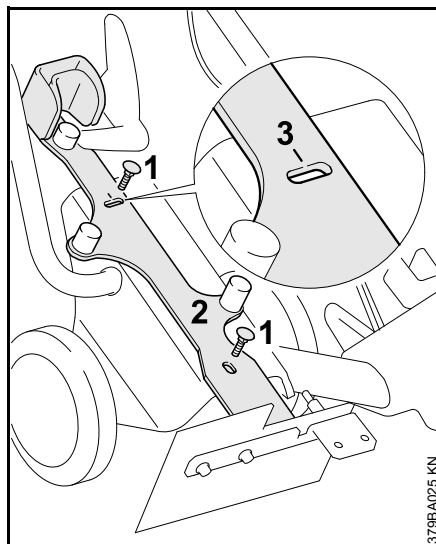

- Insert bolts (1) M8x25 from above through the oblong holes in the mount (2)
- Position the mount so that the notch (3) in the upper oblong hole is centered in relation to the bolt
- Screw on and tighten the hexagon nut with washer

Mounting the cut-off machine

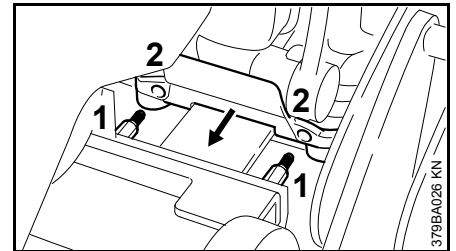

- Position the cut-off machine so that the pins (1) protrude into the holes in the support (2)

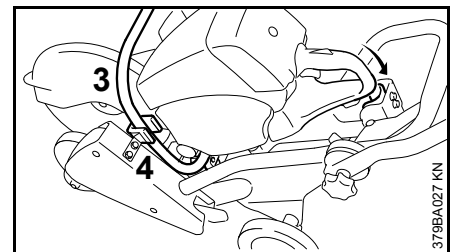

- The handlebar (3) must lie in the bracket (4)

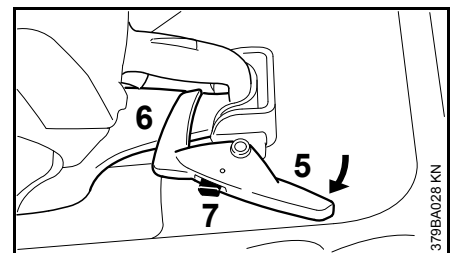

- Swivel the locking lever (5) over the hand guard (6) and engage
- The pawl (7) disengages and the handle is now fixed in place

Mounting the throttle control

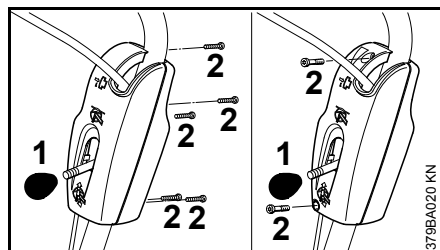

- Twist off and remove the button (1) on the lever which controls the cutting depth adjustment
- Unscrew the screws (2) and remove the moldings

Mounting the throttle cable

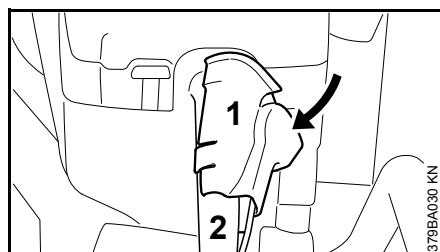

- Push the throttle cable support (1) on to the handle (2) from the side and engage in position

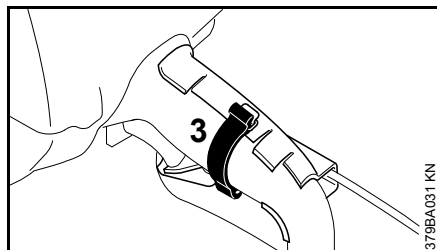

- Secure the throttle cable support with the rubber strap (3)
- Unscrew and remove the upper hexagon nut from the screw sleeve of the throttle cable

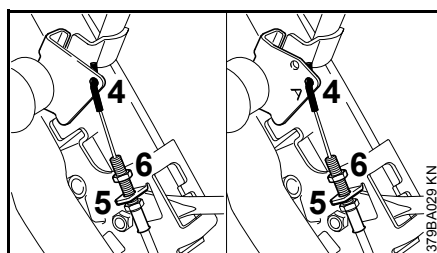

- Guide the throttle cable nipple (4) and screw sleeve through the support (5)
- Screw on hexagonal nut (6)
- Hook the throttle cable nipple into the hole (A)

Adjusting the throttle cable

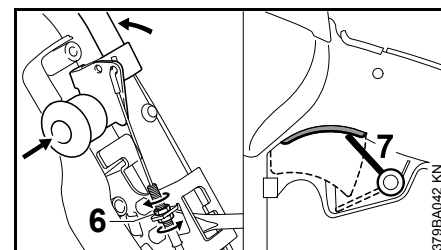

- Set the bracket bow to the full-throttle position
- Tighten the throttle cable at the lower nut until the lever (7) reaches the stop – throttle lever in full throttle position
- Tighten the hexagon nut (6)
- Release the bow – Idle position – the cut-off machine throttle lever must be in the idle position
- Screw the two moldings back together again and screw the knob back on to the lever

Dismounting the cut-off machine

- Press down the locking pawl on the locking lever and turn the locking lever away from the hand guard
- Release the rubber strap from the throttle cable support and remove the throttle cable support from the handle
- Lift out the cut-off machine

English

Trial cut

If the result of a trial cut is considerably wider than the width of the abrasive wheel segment (approximately 1.5 times the segment width), check that the abrasive wheel is correctly fitted.

Transport

The star handle can be unscrewed and the guide tube swung forwards for compact transport (remove the water tank, if fitted).